

# Drawing of waste water treatment plant BioCleaner® BC 16 B

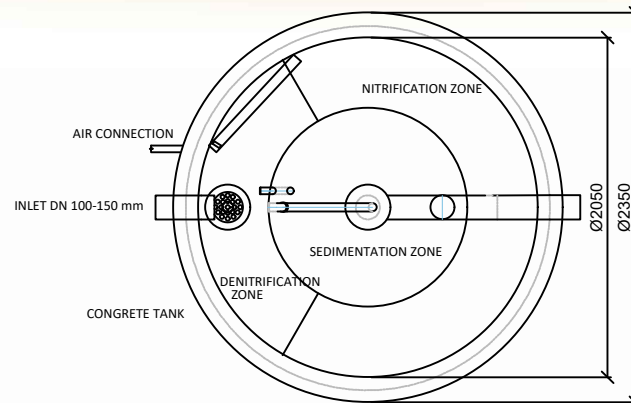

Note: Drawing of WWTP for backfill. Assembly make according to the Instruction for installation.

Volume of denitrification zone	1.46 m <sup>3</sup>	Maximum weight	5000 kg
Volume of nitrification zone	3.42 m <sup>3</sup>	Installed power	180 W
Volume of sedimentation zone	1.62 m <sup>3</sup>	Voltage	230 V
Total volume	6.50 m <sup>3</sup>	Protection of supply cable	4 A
Water level	1.97 m	Supply cabel	CYKY- J3x2.5

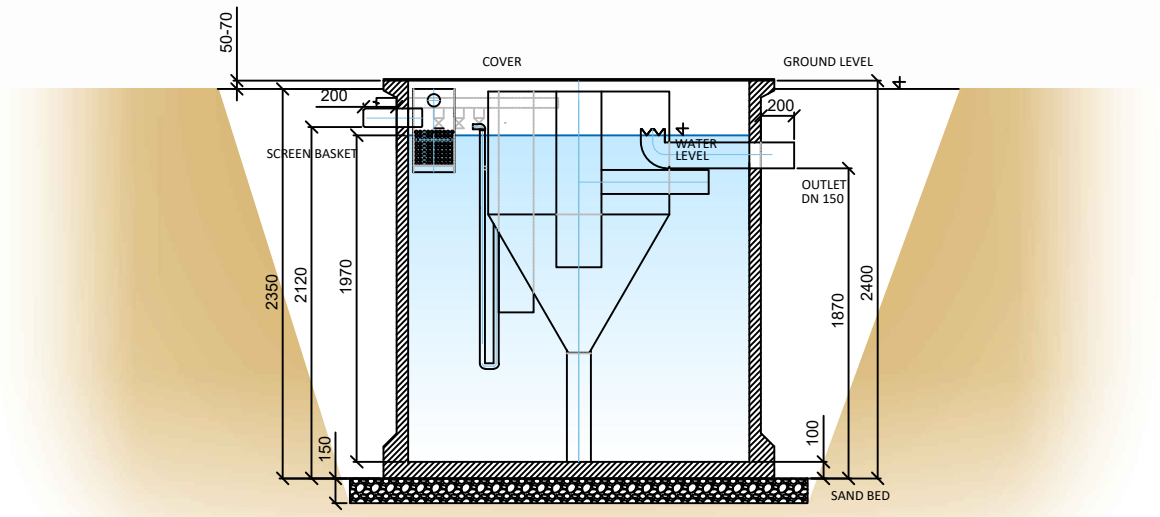